



Industrial Strength Insulated Concrete Forms (ICF)

Fox Blocks
**INSTALLATION
CHECKLIST**
2ND EDITION

INSTALLATION CHECKLISTS

The Checklists on the following pages are to help remind you of proper sequencing as well as highlight items that could be missed.

The lists will help crews continue to build efficiently at times when the lead hand is unavailable.

PHASE	JOB STATUS	WORKBOOK PAGE
1	Prior to Job	Page 3
2	Product Delivery	Page 3
3	Start of Job Check List	Page 3
4	Row 1	Page 4
5	Reinforcement	Page 4
6	Row 2	Page 5
7	Row 3	Page 5
8	Row 4	Page 5
9	Bracing	Page 6
10	Openings	Page 7
11	Top Row	Page 8
12	Prior to Concrete	Page 9
13	Multiple Levels	Page 9
14	Concrete	Page 10
15	Post Concrete	Page 11
16	Extreme Weather Concreting	Page 11

PHASE 1: PRIOR TO JOB

- 1 Blueprint shows rebar schedule or proper rebar design has been established.
- 2 Rough opening sizes are available for all window and door openings.
- 3 Wall heights have been pre-planned to determine the number of courses needed.
- 4 Height of top and/or bottom of openings are clear.
- 5 Depth of backfill is clear if needed.
- 6 Thickness of concrete is established.



PHASE 2: PRODUCT DELIVERY

- 1 Provide clear access for delivery truck.
- 2 Staging area is established for block.
- 3 Bracing and rebar should arrive at or close to the same time as ICF block.
- 4 Job is squared prior to material being moved in. *(Hard to do after)*

PHASE 3: START OF JOB

ITEMS NEEDED TO BUILD JOB:

- 1 Rebar and design
- 2 Blueprint
- 3 Buck material and opening sizes
- 4 ICF blocks
- 5 Alignment/scaffold system including screws
- 6 2 x 10 planks
- 7 Anchor bolts or Simpson Hangers
- 8 Strapping
- 9 Fox Block HV Clips

TOOLS INCLUDING:

- 1 Saws (pruning and handsaw)
- 2 Tie wire & Pliers
- 3 Spray foam adhesive
- 4 Rebar bender / cutter
- 5 Chalk and string lines
- 6 Proper signage
- 7 Table saw to rip cut block



PHASE 6: ROW 2

- 1 Start row 2 at same corner you started row 1, using the opposite corner you started with on row 1.
- 2 Place straight forms from the corner form. Webs should line up automatically.
- 3 Use Fox Block HV Clips to connect rows 1 and 2 together at 24" o/c and 1st and 3rd tie from every corner.
- 4 Once 2nd row is complete, install rebar as per plan, code, or engineering.
- 5 Check top of 2nd course to confirm level footings. Shim and/or trim as needed to be +/- 1/4"
- 6 If satisfied, kick wall to the chalk lines and spray foam to footings at 16" o/c and both sides of wall. *(Insert tip of spray foam under form so spray foam fills about 2" of space)*
- 7 Remember that courses 1,3,5,7 and courses 2,4,6,8 are all the same pattern for stacking. Once you have the first two courses stacked, this becomes your blueprint for all other courses.



PHASE 7: ROW 3

- 1 Start at same corner as row one and lay forms out along wall.
- 2 All joints should line up with joints on row one.
- 3 Use Fox Block HV Clips on 1st and 3rd tie from each corner and in both directions from corner.
- 4 If a block is to be cut, it's size should be the same as row one.
- 5 Install rebar as per plan, code, or engineering.

PHASE 8: ROW 4

- 1 Start at same corner as row one and lay forms out along wall.
- 2 All joints should line up with joints on row two.
- 3 Use Fox Block HV Clips on 1st and 3rd tie from each corner and in both directions from corner.
- 4 If a block is to be cut, it's size should be the same as row two.
- 5 Install rebar as per plan, code, or engineering.

PHASE 10: OPENINGS

FOX BUCK

- 1 Build wall as normal with opening 4" larger than rough opening called for.
- 2 Ensure all opening rebar is properly placed and secured.
- 3 Double check opening measurements.
- 4 Cut side to length and notch each end 3/4" as in photo.
- 5 Place Fox Buck sides into place and hold with tape.
- 6 Cut and place top and bottom Fox Bucks.
- 7 Penetrate all slots with a nail or screw to ensure entrapped air can escape during concrete placement.
- 8 Cut and remove all circles in sill to ensure proper concrete consolidation during concrete placement.
- 9 Brace inside opening to hold square during concrete placement.
Optional: Spray foam can be used to completely seal buck to block

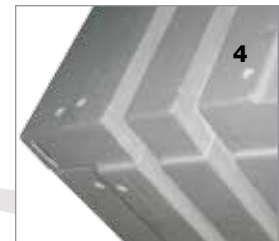
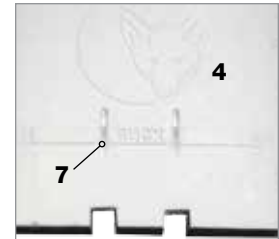
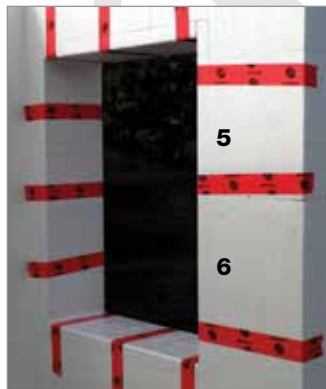

CONVENTIONAL WOOD BUCKS

- 1 Establish the bottom of buck and mark on forms.
- 2 If the outside edge of buck lines up on a tie you should alter web pattern or simply slide the buck over.
- 3 Cut the forms to accept the bucks.
- 4 If needed, install vertical rebar into spaces under the buck locations.
- 5 Bucks should be built with access points in bottom to allow for concrete placement.
- 6 Place the bucks into position on wall. Buck does not need to line up with cut lines on forms.
- 7 Build ICF forms around buck.



PHASE 12: PRIOR TO CONCRETE

- 1 Attach a string line to monitor wall during concrete placement. *(A good spot for the string line is opposite the bracing, about 2" down from the top of the wall. See notes in bracing section)*
- 2 Rebar and lintel steel is complete as per plan.
- 3 Openings have been braced and framed.
- 4 Stacked joints (any joints 8" or less apart) have been strapped.
- 5 Short wall sections (4' or less) have been strapped.
- 6 Beam pockets are in place.
- 7 Sill plate attachment is ready for installation after concrete placement.
- 8 Space is ready for concrete pump to set up.

PHASE 13: MULTIPLE LEVELS

- 1 Top of foam has been covered to protect from concrete.
- 2 Service penetrations have been installed. *(Vents, central vac exhaust etc.)*
- 3 Rebar dowels are ready to be installed.
- 4 When placing concrete, remember to leave a portion of the tie exposed. This will allow you to tie the next row down when you continue building.
- 5 Embeds installed and secured.

PHASE 14: CONCRETE

Establish concrete crew and who will be responsible for what.

- 1
 - a. One person to place concrete
 - b. Two people to consolidate concrete
 - c. One or two people leveling walls
 - d. Extra manpower on pour day is not a bad thing!
- 2 You have to tell the pump operator how many lifts you will be doing and what slump concrete you want. 2' to 4' lifts with a 5" to 6" slump is normal.
- 3 Start placing concrete at least 2' from a corner. (Never into a corner as it could move the wall). Always flow the concrete through the corner.
- 4 If the concrete gets through the top rebar with just a bit of restriction the slump is good. If the concrete flows freely past the top rebar the slump could be too high.
- 5 Create a lift of concrete on either side of corner before actually filling the corner. These lifts on either side act as an anchor holding the corner in place.
- 6 At a window, fill from one side and let the concrete flow under the window buck, then stop the pump, move to the opposite side of the buck, and continue. Some windows will require extra concrete be placed into the opening at bottom of buck.
- 7 Consolidate concrete during each lift following the person who is placing concrete.
- 8 Leave at least 18" to 24" at top of wall for final lift. This will allow concrete pump to keep up.
- 9 Monitor walls during and after concrete placement and then adjust turnbuckles to level walls.
- 10 If required, install anchor bolts.
- 11 Ensure all window and door bucks have been consolidated properly by hitting their face all around with a hammer.
- 12 Clean concrete off footings, slabs, scaffold, walls, tools etc.
- 13 Before leaving, take one last look to ensure your walls are straight and plumb.

PHASE 15: POST CONCRETE

- 1 Bracing should be left in place for 72 hours after concrete placement. If you must remove bracing, from 24 to 72 hours after concrete placement, it is recommended that you place temporary bracing against walls prior to removing ICF bracing.
 - 2 Damp proofing may be required according to building code. *(Peel & Stick and/or dimple membranes have been the most common damp proofing methods for ICFs.)*
 - 3 Prior to backfill, you may need to have floor diaphragm in place according to building code.
-
-
-

PHASE 16: EXTREME WEATHER CONCRETING

When building with ICFs in extreme weather, there are just a few additional precautions that need to be taken.

- 1 Keep walls covered to keep snow out of wall cavity. Concrete does not melt snow.
 - 2 If you get snow into the wall cavity you must remove it prior to concrete placement. This can be done by cutting temporary holes into the bottom of forms or drizzling hot water into the forms. Hot water comes on the mixer trucks in winter.
 - 3 Use 18" wide insulated tarps or equivalent along top of wall.
 - 4 In very cold weather (-0° F / -20° C), only lift off 8' of insulation at a time while placing concrete. This will allow the warmth of the concrete to preheat the wall and rebar during the pour.
 - 5 When complete, cover the wall to protect concrete from cooling. The hydration process will keep the wall at a good temperature without the need for any extra hoarding or heating.
 - 6 Remember to cover exposed concrete at bucks.
 - 7 In very hot weather, keep exposed concrete covered and apply moisture.
-
-
-

